



Annapurna Nirman

CONTRACTORS, DEVELOPERS & ENGINEERS

email : annapurnagroup2013@gmail.com

Website : www.annapurnagroup.net

Ph.: 033-2583-6777

GST IN : 19AAZFA0012H1ZI

13/12/A/44, Khardah Station Road, Shreyashi Apartment, P.O. - Khardah, Kolkata-700 117

Ref.....

Date.....

LOCATION DETAILS OF THE PROJECT OF LAND DEDICATED FOR THE PROJECT DEVELOPMENT ALONGWITH ITS BOUNDARIES INCLUDING THE LATITUDE & LONGITUDE OF END-POINTS OF THE PROJECT.

DEVELOPER'S NAME - ANNAPURNA NIRMAN

PROPOSED SITE - MANGALAM RESIDENCY (TOWER - II)

LATITUDE - 22.723657 = 22°43'25.16484"N

LONGITUDE - 88.367997 = 88°22'4.78848"E

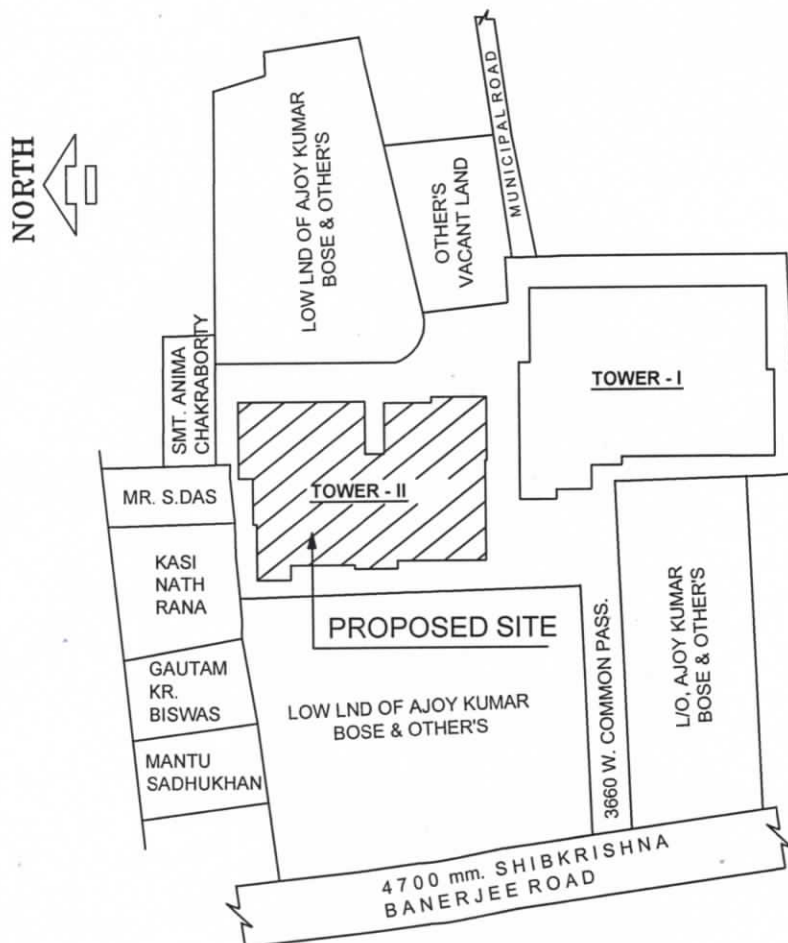

LOCATION MAP

SCALE = 1 : 600

ANNAPURNA NIRMAN

Asim Bose Roy
Partner

Ajit Das

Ajit Das

8/8 Balaknathala

Rashkhola, Khardah

LIC No.- 11723438

SIGNATURE OF L.B.S.